

SKYWAYS SHADE NOTES:  
 BUILDING CODE IBC 2015  
 WIND LOAD OF 105 MPH  
 160 MPH WIND LOAD FRAME ONLY-NO FABRIC  
 SNOW LOAD OF 5 PSF-DOES NOT INCLUDE SNOW DRIFT  
 PROPER ACCESS TO SITE FOR MATERIALS & EQUIPMENT DELIVERY  
 STANDARD COLOR FABRIC  
 PRICE INCLUDES ANCHOR BOLTS (NON-GALVANIZED) IF REQUIRED  
 PRICE INCLUDES GENERIC SEAL DRAWINGS (ELECTRONIC FORMAT ONLY)  
 PRICE INCLUDES ZINC RICH PRIMER  
 USE OR SALES TAX NOT INCLUDED  
 INSTALLATION NOT INCLUDED  
 ALL COMPONENTS TO BE SHIPPED AT THE SAME TIME

THIS DRAWING HAS A SKYWAYS  
 SHADE ON IT, A SEPARATE  
 FREIGHT QUOTE FROM DALLAS  
 SKYWAYS FACILITY IS REQUIRED

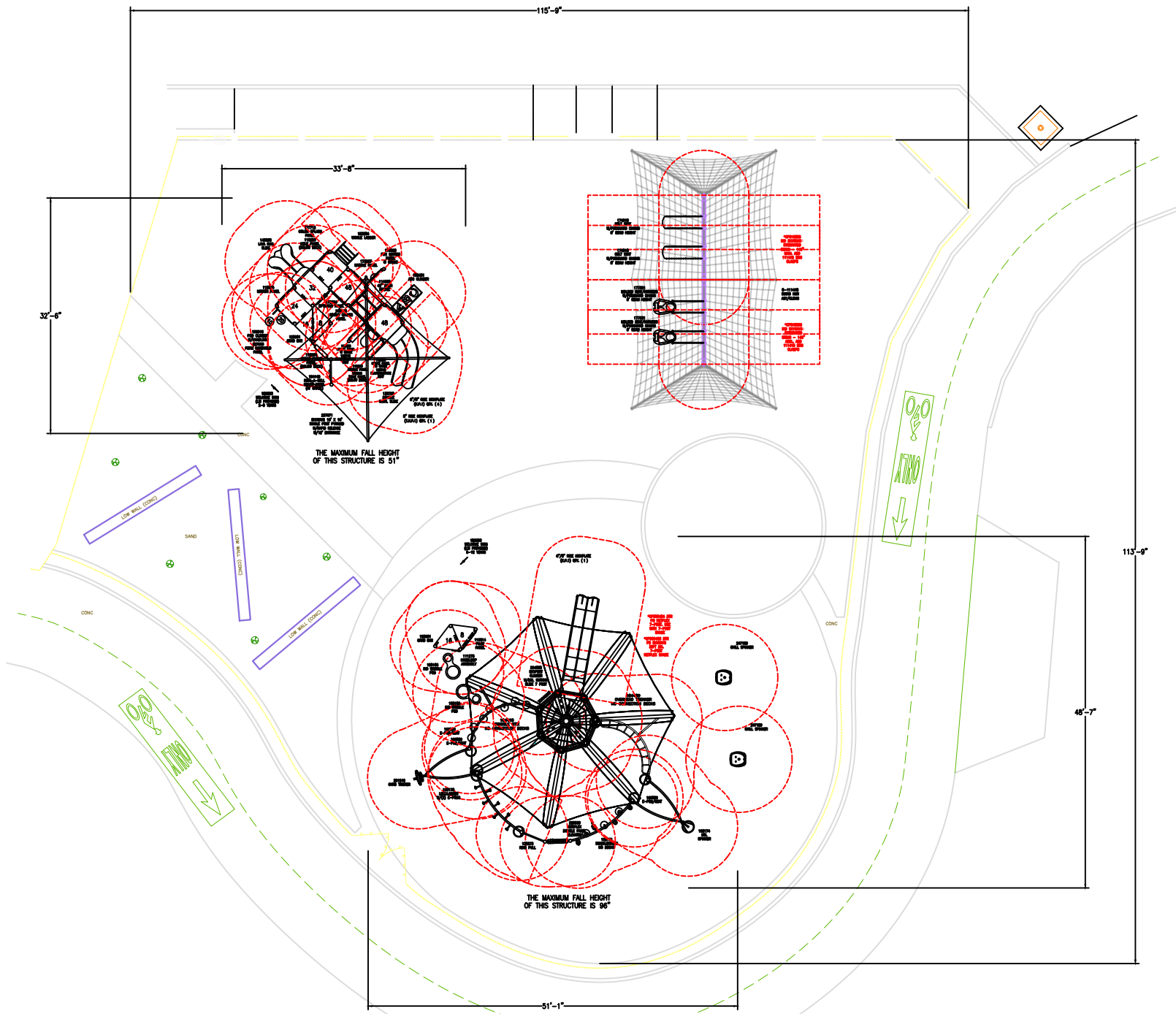

2-5 AGE  
 Estimated manufacturing time:  
 6 weeks from the time of  
 LSI order acceptance, or receipt of  
 Skyways release of fabrication  
 form if applicable.  
 PlayBooster  
 (2-5 years)  
 Max Fall Height: 51 inches

TOTAL ELEVATED PLAY COMPONENTS	11		
TOTAL ELEVATED COMPONENTS ACCESSIBLE BY RAMP	0	REQUIRED	0
TOTAL ELEVATED COMPONENTS ACCESSIBLE BY TRANSFER	11	REQUIRED	6
TOTAL ACCESSIBLE GROUND LEVEL COMPONENTS SHOWN	4	REQUIRED	4
TOTAL DIFFERENT TYPES OF GROUND LEVEL COMPONENTS	4	REQUIRED	4

5-12 AGE  
 Estimated manufacturing time:  
 6 weeks from the time of  
 LSI order acceptance, or receipt of  
 Skyways release of fabrication  
 form if applicable.  
 PlayBooster and Parts  
 (5-12 years)  
 Max Fall Height: 90 inches

TOTAL ELEVATED PLAY COMPONENTS	4		
TOTAL ELEVATED COMPONENTS ACCESSIBLE BY RAMP	0	REQUIRED	0
TOTAL ELEVATED COMPONENTS ACCESSIBLE BY TRANSFER	2	REQUIRED	2
TOTAL ACCESSIBLE GROUND LEVEL COMPONENTS SHOWN	15	REQUIRED	2
TOTAL DIFFERENT TYPES OF GROUND LEVEL COMPONENTS	11	REQUIRED	11

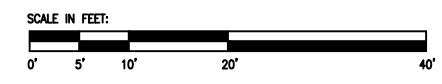

Venice Beach Park

Landscape Structures, Inc.

SYSTEM TYPE:  
 PlayBooster

DRAWING #:  
 1166404-01-01



The play components identified on this plan are IPEMA certified. (Unless model number is preceded with \*) The use and layout of these components conform to the requirements of ASTM F1487. To verify product certification, visit www.ipema.org

THIS PLAY AREA & PLAY EQUIPMENT IS DESIGNED FOR AGES 2-12 YEARS UNLESS OTHERWISE NOTED ON PLAN.

IT IS THE MANUFACTURERS OPINION THAT THIS PLAY AREA DOES CONFORM TO THE A.D.A. ACCESSIBILITY STANDARDS, ASSUMING AN ACCESSIBLE PROTECTIVE SURFACING IS PROVIDED, AS INDICATED, OR WITHIN THE ENTIRE USE ZONE.

THIS CONCEPTUAL PLAN WAS BASED ON INFORMATION AVAILABLE TO US. PRIOR TO CONSTRUCTION, DETAILED SITE INFORMATION INCLUDING SITE DIMENSIONS, TOPOGRAPHY, EXISTING UTILITIES, SOIL CONDITIONS, AND DRAINAGE SOLUTIONS SHOULD BE OBTAINED, EVALUATED, & UTILIZED IN THE FINAL DESIGN. PLEASE VERIFY ALL DIMENSIONS OF PLAY AREA, SIZE, ORIENTATION, AND LOCATION OF ALL EXISTING UTILITIES, EQUIPMENT, AND SITE FURNISHINGS PRIOR TO ORDERING. SLIDES SHOULD NOT FACE THE HOT AFTERNOON SUN.

CHOOSE A PROTECTIVE SURFACING MATERIAL THAT HAS A CRITICAL HEIGHT VALUE TO MEET THE MAXIMUM FALL HEIGHT FOR THE EQUIPMENT (REF. ASTM F1487 STANDARD CONSUMER SAFETY PERFORMANCE SPECIFICATION FOR PLAYGROUND EQUIPMENT FOR PUBLIC USE, SECTION 8 CURRENT REVISION). THE SUBSURFACE MUST BE WELL DRAINED. IF THE SOIL DOES NOT DRAIN NATURALLY IT MUST BE TILED OR SLOPED 1/8" TO 1/4" PER FOOT TO A STORM SEWER OR A "FRENCH DRAIN".

IT IS THE MANUFACTURER'S OPINION AND INTENT THAT THE LAYOUT OF THESE COMPONENTS CONFORM WITH THE U.S. CONSUMER PRODUCT SAFETY COMMISSION'S (CPSC) "HANDBOOK FOR PUBLIC PLAYGROUND SAFETY".

DESIGNED BY:

COPYRIGHT: 4/15/22  
 LANDSCAPE STRUCTURES, INC.  
 601 7th STREET SOUTH - P.O. BOX 198  
 DELANO, MINNESOTA 55328  
 PH: 1-800-328-0035 FAX: 1-763-972-6091

Date	Previous Drawing #	Initials

