

Estimated manufacturing time:  
4 weeks from the time of  
LSI order acceptance, or receipt of  
SkyWays release of fabrication  
form if applicable.

landscape  
structures



The play components identified on this plan are IPEMA certified. (Unless otherwise noted) The use and layout of these components conform to the Canadian Standards Association (CSA) Standard CAN/CSA-2614. To verify product certification, visit [www.ipema.org](http://www.ipema.org).

THIS PLAY AREA & PLAY EQUIPMENT IS  
DESIGNED FOR AGES 8-144 MOS  
UNLESS OTHERWISE NOTED ON PLAN.

THIS CONCEPTUAL PLAN WAS BASED ON  
INFORMATION AVAILABLE TO US. PRIOR TO  
CONSTRUCTION, DETAILED SITE INFORMATION  
INCLUDING SITE DIMENSIONS, TOPOGRAPHY, EXISTING  
UTILITIES, SOIL CONDITIONS, AND DRAINAGE  
SOLUTIONS SHOULD BE OBTAINED, EVALUATED, &  
UTILIZED IN THE FINAL DESIGN. PLEASE VERIFY ALL  
DIMENSIONS OF PLAY AREA, SIZE, ORIENTATION, AND  
LOCATION OF ALL EXISTING UTILITIES, EQUIPMENT,  
AND SITE FURNISHINGS PRIOR TO ORDERING. SLIDES  
SHOULD NOT FACE THE HOT AFTERNOON SUN.

CHOOSE A PROTECTIVE SURFACING MATERIAL THAT  
HAS A CRITICAL HEIGHT VALUE TO MEET THE  
MAXIMUM FALL HEIGHT FOR THE EQUIPMENT (REF.  
ASTM F1487 STANDARD CONSUMER SAFETY  
PERFORMANCE SPECIFICATION FOR PLAYGROUND  
EQUIPMENT FOR PUBLIC USE, SECTION 8 CURRENT  
REVISION). THE SUBSURFACE MUST BE WELL  
DRAINED. IF THE SOIL DOES NOT DRAIN NATURALLY  
IT MUST BE TILED OR SLOPED 1/8" TO 1/4" PER  
FOOT TO A STORM SEWER OR A "FRENCH DRAIN".

DESIGNED BY:

COPYRIGHT: 9/12/22  
LANDSCAPE STRUCTURES, INC.  
601 7th STREET SOUTH - P.O. BOX 198  
DELANO, MINNESOTA 55328  
PH: 1-800-328-0035 FAX: 1-763-972-6091

Date	Previous Drawing #	Initials

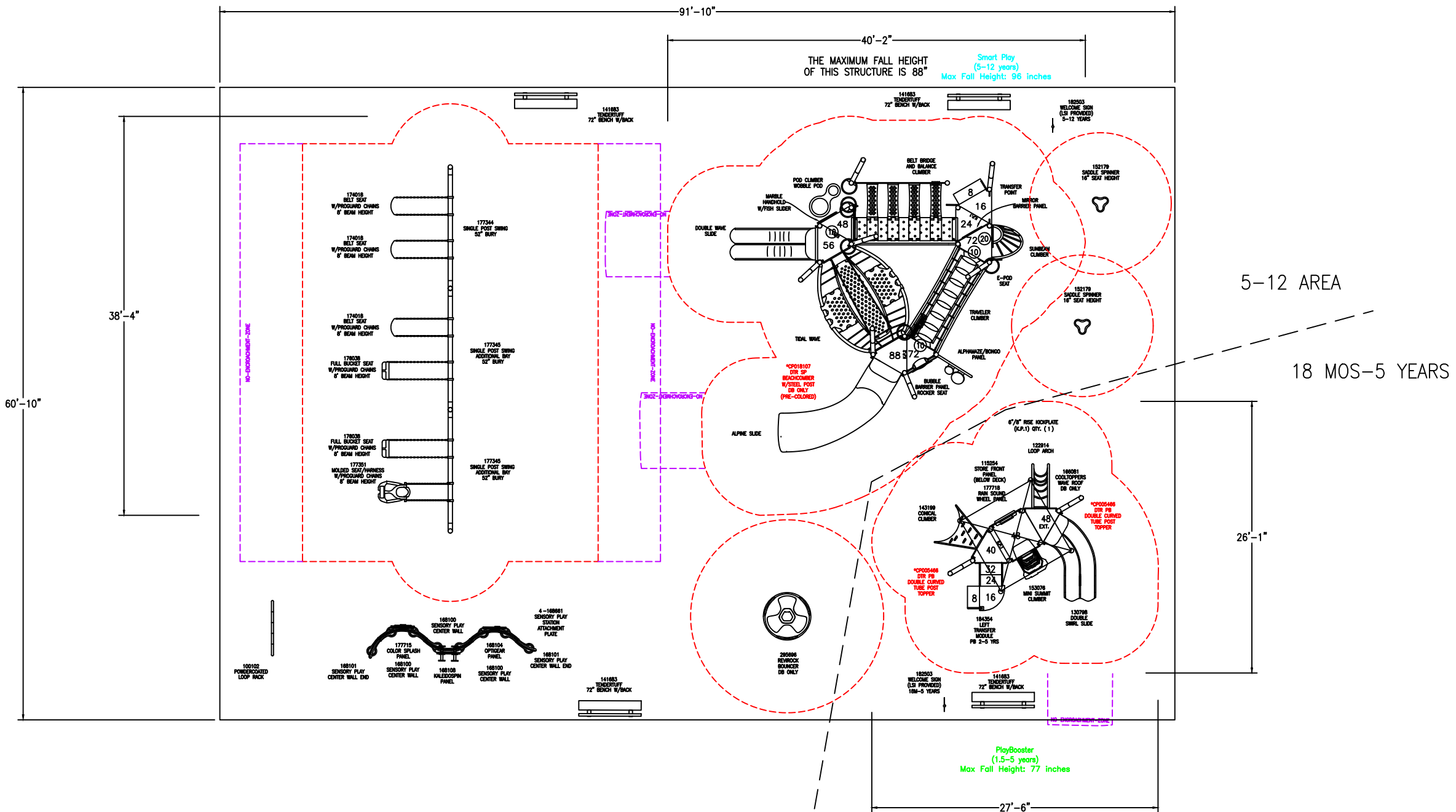

Estimated manufacturing time:  
4 weeks from the time of  
LSI order acceptance, or receipt of  
SkyWays release of fabrication  
form if applicable.

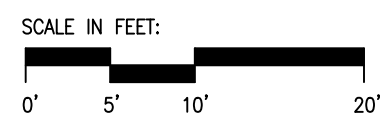

Wilson Park

Landscape  
Structures, Inc.

SYSTEM TYPE:  
PlayBooster

DRAWING #:  
1168212-01-01