

| NO | PRODUCT                      | QTY | GPM   | LINE SIZE |
|----|------------------------------|-----|-------|-----------|
| 1  | RIPPLERUN W/ ACRYLIC, MEDIUM | 1   | 10    | 1"        |
| 2  | TOT WELLSPRING               | 1   | 10    | 1"        |
| 3  | ROCKETSTREAM                 | 2   | 5 EA. | 1" EA.    |
| 4  | CURVY JET MANIFOLD           | 1   | 8     | 1"        |
| 5  | SEA CRAWLER                  | 2   | 5 EA. | 1" EA.    |
| 6  | ARCH JET                     | 2   | 5 EA. | 1" EA.    |
| 7  | HYDROLOGIX®                  | 1   | N/A   | N/A       |
| 8  | SPLASH PAD USER SIGN         | 1   | N/A   | N/A       |

SPLASH PAD AREA: 1,257 SQ. FT.  
APRON AREA: 707 SQ. FT.  
TOTAL AREA: 1,964 SQ. FT.  
TOTAL FEATURE FLOW RATE: 58 GPM

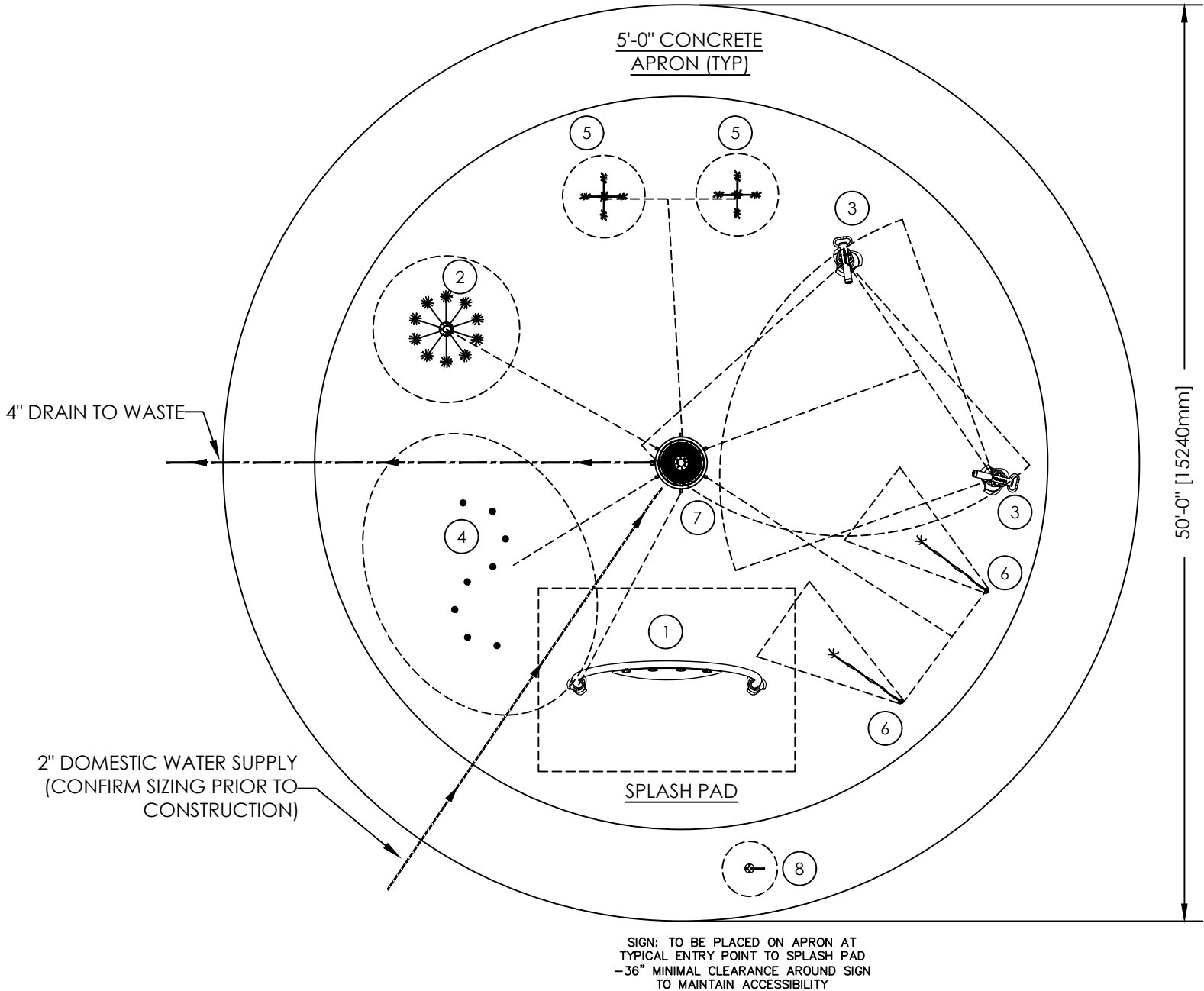

NOT FOR  
CONSTRUCTION

|   |  |  |  |                |  |              |  |       |              |  |  |           |  |                  |  |                         |                 |  |  |  |     |          |      |
|---|--|--|--|----------------|--|--------------|--|-------|--------------|--|--|-----------|--|------------------|--|-------------------------|-----------------|--|--|--|-----|----------|------|
| <div><div></div><div>1<br/>OF<br/>2</div></div> |  |  |  | JOB NO.<br>XXX |  | NOT TO SCALE |  | SCALE | DRAWN<br>XXX | SHEET TITLE<br>PROPOSED SPLASH PAD<br>SCHEMATIC LAYOUT |  | DWG. FILE |  | DATE<br>XX/XX/XX | JOB TITLE<br>AQUASWART PACKAGE A<br>SPLASH PAD |                         | LOCATION<br>XXX |  | 1101 McKinley Pkwy<br>Delano, MN 55328<br>888-438-6574<br>763-972-5200<br>aquatixplaylsi.com |  | NO. | REVISION | DATE |
|   |  |  |  |                |  |              |  |       |              |  |  |           |  | aquatix          |  | by landscape structures |                 |  |  |  |     |          |      |

- NOTE:
- ALL CONCRETE SLOPES TO BE 1/8"/FT MIN. AND 1/4"/FT MAX.
  - SITE ELEVATIONS OF SPLASH PAD AND CONCRETE APRON TO BE VERIFIED BY OTHERS. AQUATIX ELEVATION REFERENCE IS 0'-0" FOR TOP OF DRAIN BOX. ALL OTHER NOTED ELEVATIONS ARE REFERENCED FROM THAT POINT. REFER TO SPEC SHEET AND INSTALLATION DRAWING FOR EACH PRODUCT.
  - ACTUAL SIZE, SHAPE, AND LOCATION OF SPLASH PAD TO BE FIELD DETERMINED BY OTHERS. ALL DIMENSIONS OF SIZE AND SHAPE OF SPLASH PAD FOR REFERENCE ONLY.
  - THE INTENT OF A SPLASH PAD IS TO BE A DRY DECK WITH NO STANDING WATER. THE WATER IS TO BE CONTAINED WITHIN THE PERIMETER OF THE SPLASH PAD AND ALL WATER IS TO DRAIN INTO THE DRAIN BOXES. THE CONCRETE IS TO BE FORMED AND SLOPED TO ACCOMMODATE THIS DRAIN PATTERN.
  - ALL TREATED SPLASH PAD WATER IS INTENDED TO REMAIN WITHIN DESIGNATED SPLASH PAD DECK. UNDER NO CIRCUMSTANCES SHOULD SLOPE OF SPLASH PAD ALLOW WATER TO DRAIN OFF PAD.
  - UNDER NO CIRCUMSTANCES SHALL THE SURROUNDING HARDSCAPE AREA BE SLOPED TO ALLOW WATER TO BE DRAINED INTO THE SPLASH PAD DECK.
  - ALL CONCRETE SURFACES TO HAVE A MEDIUM BROOM FINISH.
  - EXPANSION JOINT TO BE EVERY 20'x20'. SAW CUT JOINT TO BE EVERY 10'x10'. COORDINATE EXPANSION JOINT AND SAW CUT LOCATIONS WITH PLAY EQUIPMENT LOCATIONS.
  - DRAWINGS ARE FOR DESIGN/LAYOUT PURPOSES ONLY. PLEASE SEE AQUATIX BY LANDSCAPE STRUCTURES FOR INCLUDED STRUCTURES, EQUIPMENT, SERVICES, AND EXCLUSIONS.
  - — — INDICATES SPLASH ZONE.
  - SPLASH ZONES ARE APPROXIMATE. ACTUAL SPLASH ZONE MAY VARY BASED ON VARIOUS ENVIRONMENTAL CONDITIONS, FLOW RATES, SLOPE OF THE SPLASH PAD, SUBMERGENCE DEPTH AND WIND.
  - DRAWINGS ARE SCHEMATIC ONLY.
  - 18" OF GRANULAR FILL RECOMMENDED, OR AS SOIL CONDITIONS AND/OR LOCAL CODE REQUIRES WITH A MINIMUM OF 2500 PSF SOIL BEARING CAPACITY THERE IS TO BE A MINIMUM OF 6" OF GRANULAR FILL AROUND ALL PIPING.
  - CONCRETE REINFORCEMENT TO BE #4 REBAR @12" O.C. EACH WAY OR EQUIVALENT WELDED WIRE MESH (W6 ON 4"X4" SPACING OR W10 ON 6"X6" SPACING)
  - CONCRETE TO BE THICKENED AT ALL PRODUCT INSTALLATION LOCATIONS (BOTH EMBED AND ABOVE GROUND STRUCTURES). REFER TO INSTALLATION DRAWINGS FOR EACH PRODUCT.
  - SCHEDULE 80 PVC TO BE UTILIZED FOR ALL SPLASH PAD MECHANICAL SYSTEM PIPING.
  - LEVEL MOUNTING AREA REQUIRED FOR ALL PRODUCTS. RECOMMENDED POOL WATER DEPTHS:  
-DO NOT EXCEED 6" WATER DEPTH ON GROUND SPRAYS AND STRUCTURES UP TO 24" TALL  
-DO NOT EXCEED 12" WATER DEPTH ON STRUCTURES UP TO 48" TALL  
-DO NOT EXCEED 18" WATER DEPTH ON STRUCTURES TALLER THAN 48"  
-DO NOT EXCEED 12" WATER DEPTH ON MULTI LEVEL PLATFORMS . NO WATER SPRAY OR CRAWL TUNNEL TO BE UNDERWATER.
  - THICKENED AND LEVEL SLABS REQUIRED UNDER ENTIRE MULTI LEVEL STRUCTURES.

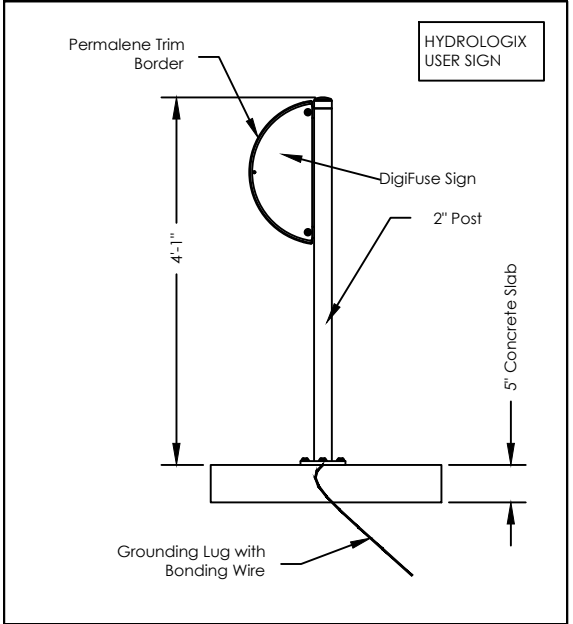
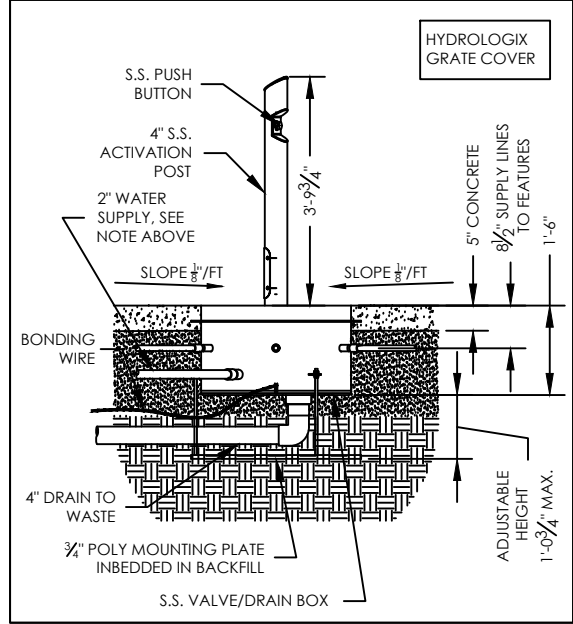
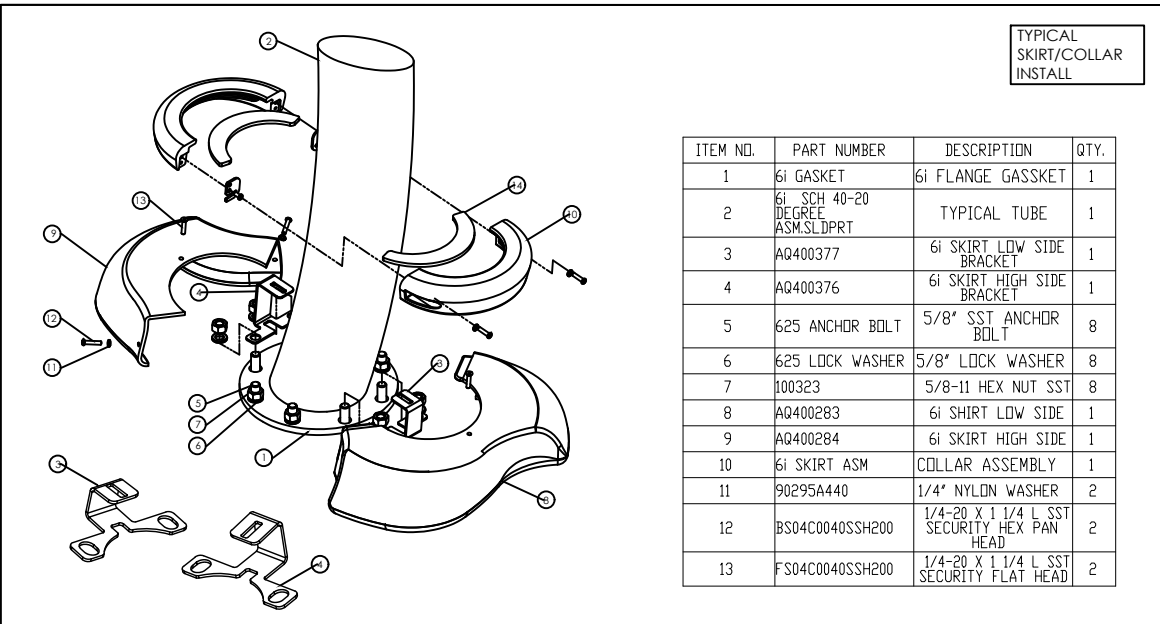
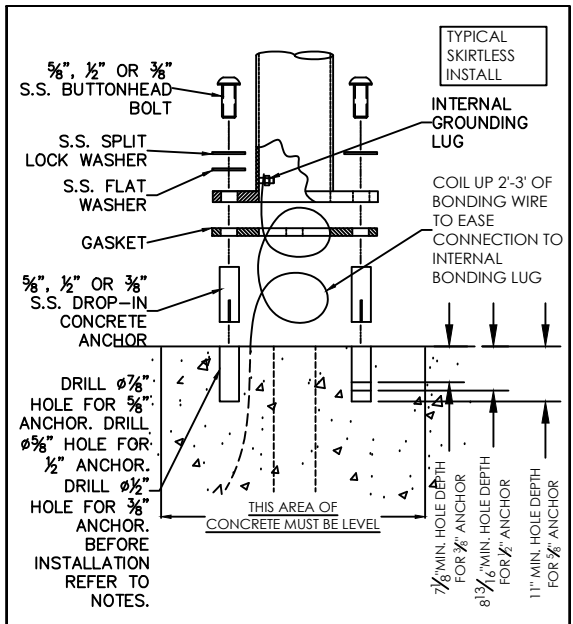
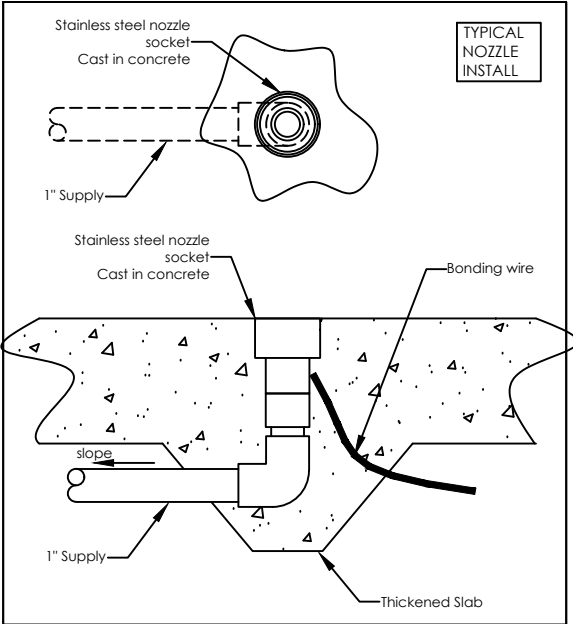
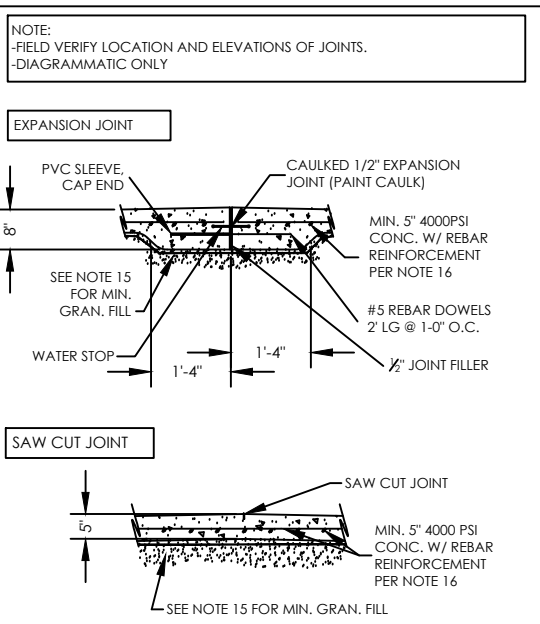
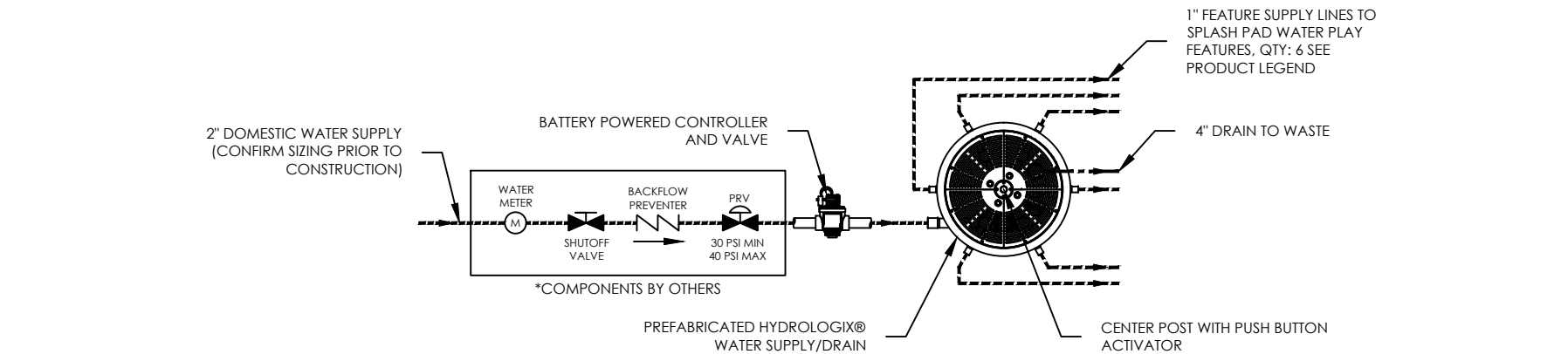

NOT FOR  
CONSTRUCTION