

NOTES

1. Valve must be installed on supply line to regulate flow.
2. Concrete mounting surface for structure installation needs to be level and flat.
3. Supply line is based on the designated flow rates for structure.
4. Underground plumbing to be designed for winterization.
5. Consult local electrical inspector for grounding.
6. Concrete to be rated for 4000 psi minimum before installing structure. Approx. 28 days of curing to reach rate.
7. Product may require a strainer on the water feed line. Consult with manufacturer.
8. Product specifications are subject to change.

Splash Zone-Not to Scale

Splash Zone Notes:

Splash zones are approximate, actual splash may vary based on various environmental conditions, flow rates, slope of splash pad, submergence depth and wind.

PRODUCT MATERIAL

Structure:

Stainless Steel Fabrication
(see specifications for details)

Acrylic Accents
(see specifications for details)

Deck Heights
Step = 7"
Platform 1 = 14"
Platform 2 = 21"
Platform 3 = 28" (Slide)
Platform 4 = 36" (Slide)
Platform 5 = 60" (Mega Slide)
Platform 6 = 67"
Platform 7 = 74" (Slide with Runnel)

DATA

Flow Range: 200-300 GPM
Supply Line: (2) 4" Lines
Installation: Flange Mount to Concrete
*Level Mounting Area Req'd

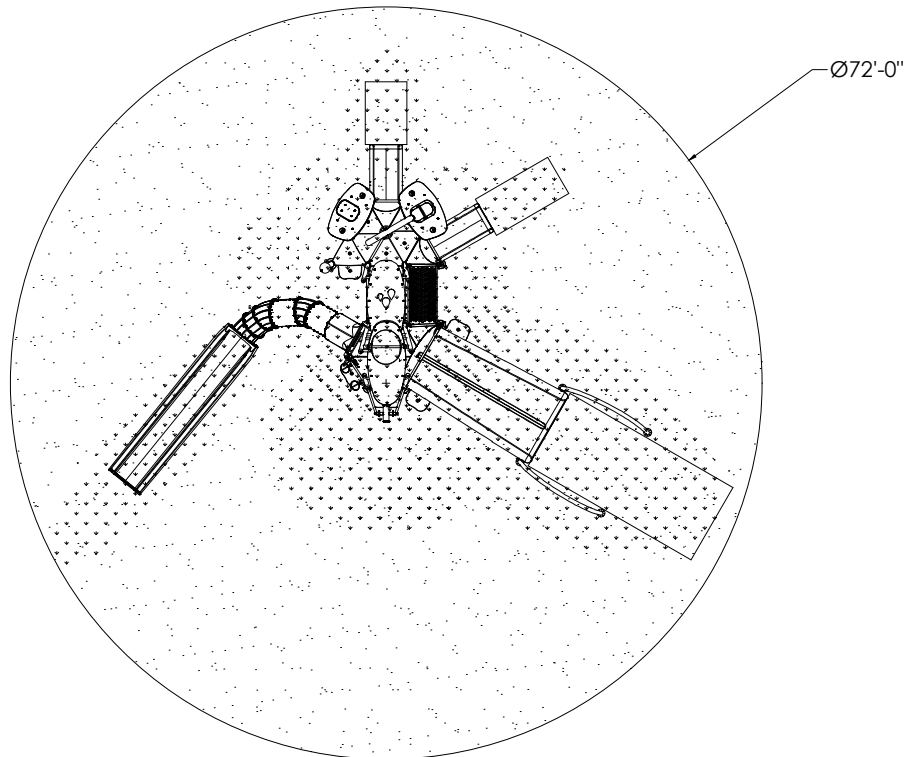

1101 McKinley Parkway
Delano, MN 55328
888-438-6574
763-972-5200
aquatix.playlsi.com

HYDRAHUB 2

DRAWN BY	JLS	SCALE	N.T.S	DATE	8/22/23
REVISED BY	NCS	REVISION LETTER	C	REVISION DATE	2/5/2025

This drawing is issued in confidence for engineering information only. This drawing shall remain the property of Aquatix and may not be reproduced, disclosed to a third party, or used to manufacture anything without direct written permission from Aquatix. Unauthorized use shall entitle Aquatix to all damages caused by such user including preparation charges, lost profits, damage to reputation and attorney's fees.

TOP VIEW

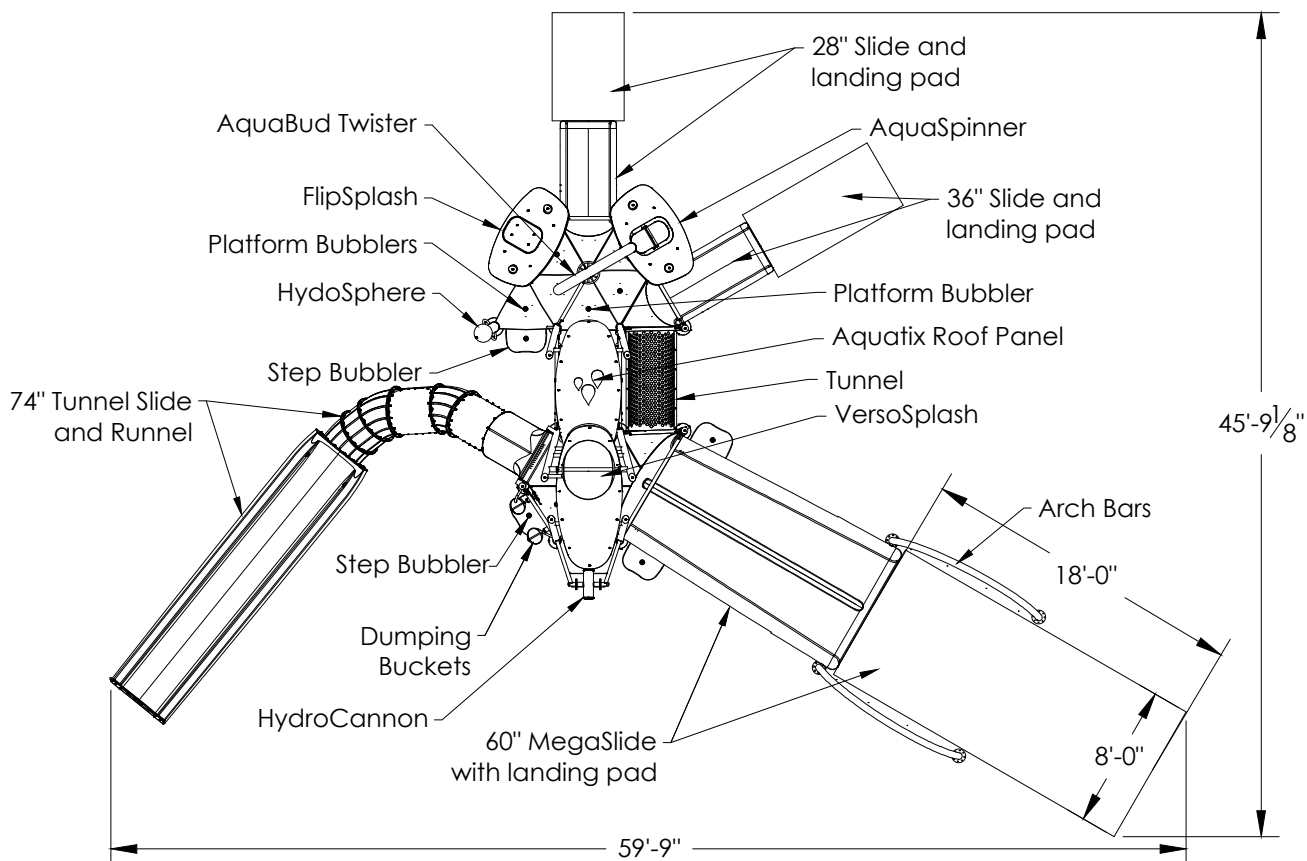

FRONT VIEW

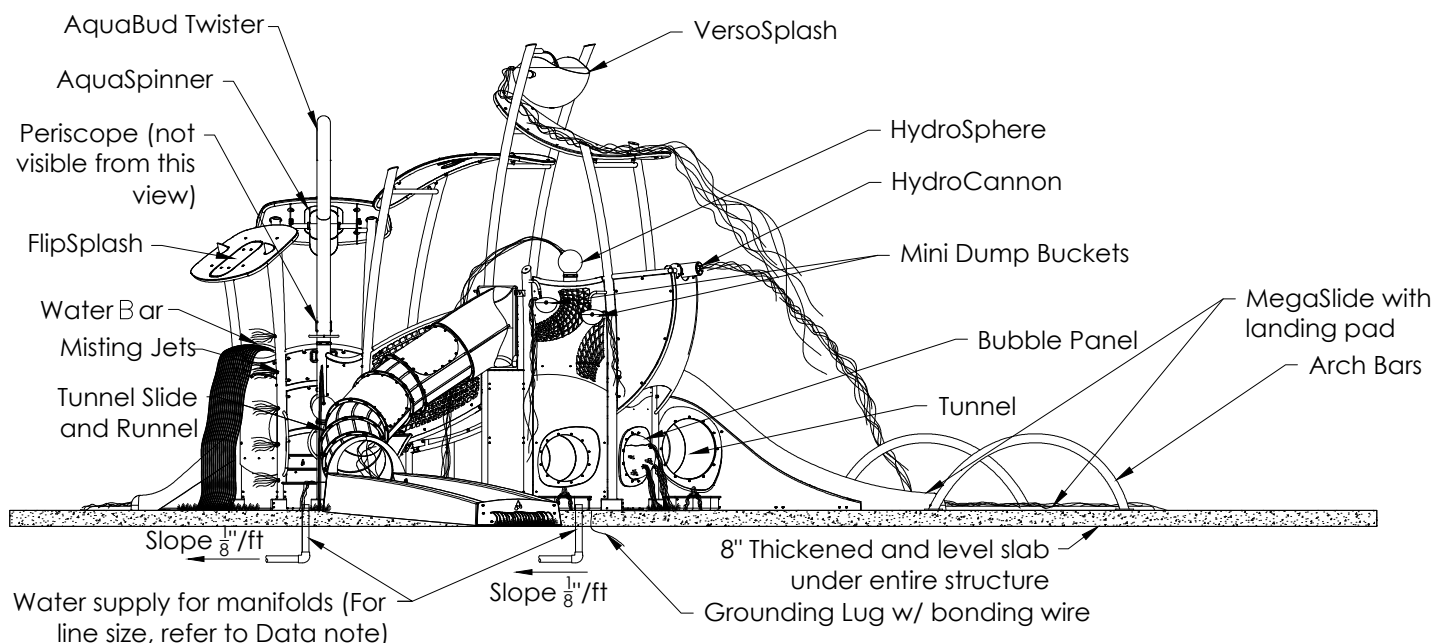

Not for Construction



1101 McKinley Parkway
Delano, MN 55328
888-438-6574
763-972-5200
aquatix.playlsi.com

HYDRAHUB 2

DRAWN BY	JLS	SCALE	N.T.S	DATE	8/22/23
REVISED BY	NCS	REVISION LETTER	C	REVISION DATE	2/5/2025

This drawing is issued in confidence for engineering information only. This drawing shall remain the property of Aquatix and may not be reproduced, disclosed to a third party, or used to manufacture anything without direct written permission from Aquatix. Unauthorized use shall entitle Aquatix to all damages caused by such user including preparation charges, lost profits, damage to reputation and attorney's fees.

ALTERNATE VIEW

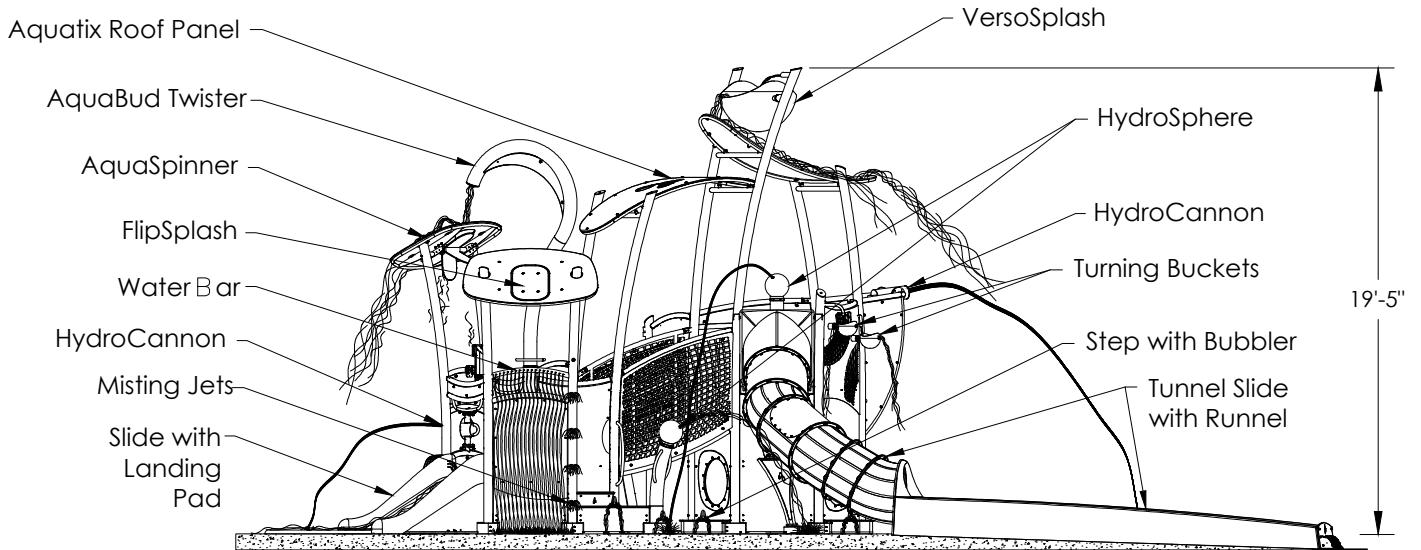

WATER EFFECTS

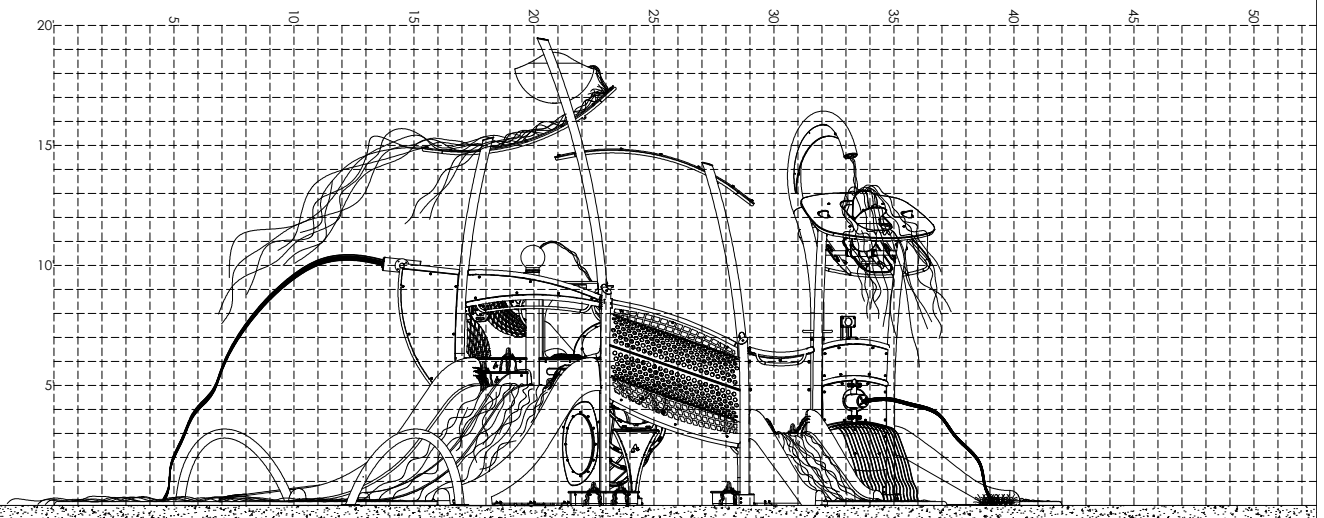

1101 McKinley Parkway
Delano, MN 55328
888-438-6574
763-972-5200
aquatix.playlsi.com

HYDRAHUB 2

DRAWN BY	JLS	SCALE	N.T.S	DATE	8/22/23
REVISED BY	NCS	REVISION LETTER	C	REVISION DATE	2/5/2025

This drawing is issued in confidence for engineering information only. This drawing shall remain the property of Aquatix and may not be reproduced, disclosed to a third party, or used to manufacture anything without direct written permission from Aquatix. Unauthorized use shall entitle Aquatix to all damages caused by such user including preparation charges, lost profits, damage to reputation and attorney's fees.

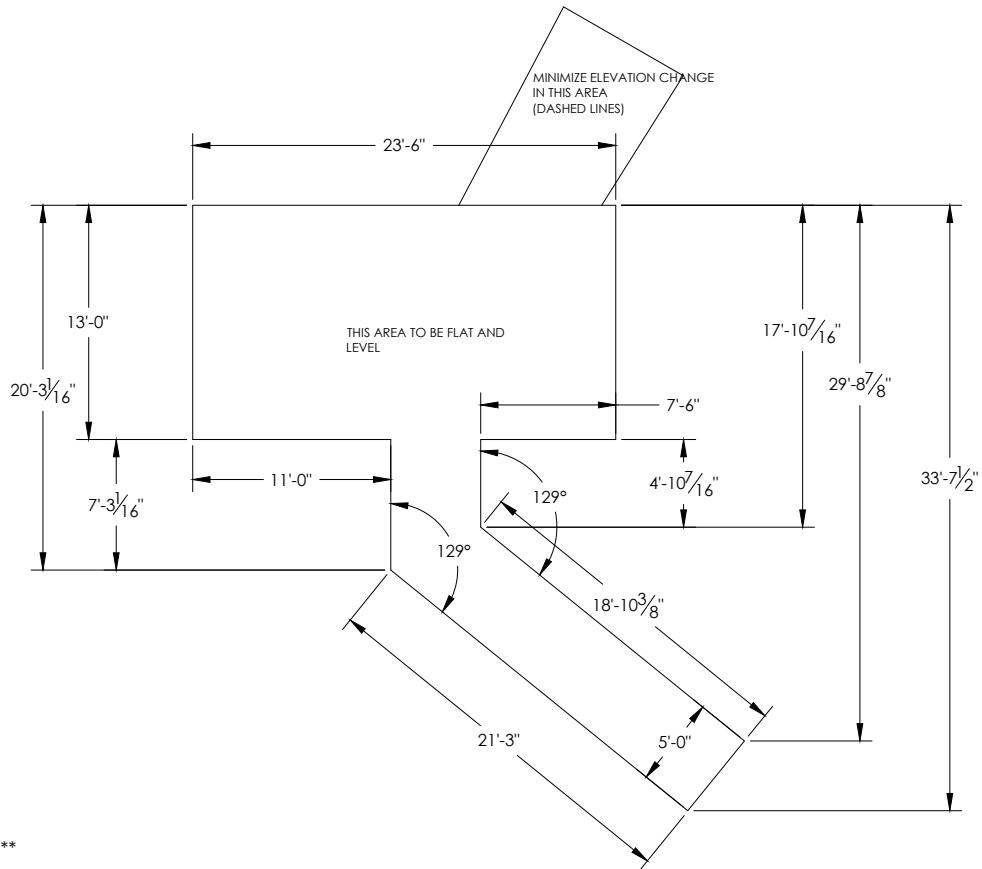
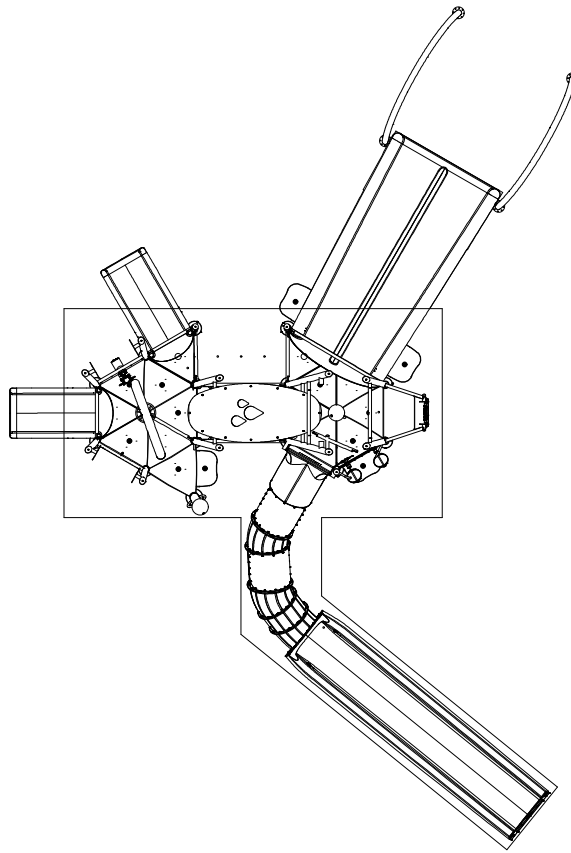

Not for Construction



1101 McKinley Parkway
Delano, MN 55328
888-438-6574
763-972-5200
aquatix.playlsi.com

HYDRAHUB 2 CONCRETE

DRAWN BY	JLS	SCALE	N.T.S	DATE	8/22/23
REVISED BY	NCS	REVISION LETTER	C	REVISION DATE	2/5/2025

This drawing is issued in confidence for engineering information only. This drawing shall remain the property of Aquatix and may not be reproduced, disclosed to a third party, or used to manufacture anything without direct written permission from Aquatix. Unauthorized use shall entitle Aquatix to all damages caused by such user including preparation charges, lost profits, damage to reputation and attorney's fees.